

Installation Instructions



Return Plenum Using Installation Frame

Launched in 2016, a new filter mounting frame allows installers the choice of filter access - from behind the unit or via a slide rail.

Return plenums are supplied with two components - the plenum box and an installation frame as shown opposite.



1. Remove air filter from fan coil unit
2. Remove end cap from filter frame
3. Slide plenum box towards the end opening free from retaining lugs and then lift away
4. Locate mounting frame on to the back of the air conditioning fan coil unit.
5. Fix installation frame to fan coil chassis using the screws provided.
6. Take care to ensure that screws are fully countersunk. If not the air filter may catch on a proud screw.
7. Slide the air filter into the installation frame checking for free movement.
8. Refit the plenum box by sliding flange into retaining lugs.
9. Refit end sealing plate.
10. If the filter cannot be removed by side withdrawal perhaps due to a wall or other obstruction, ensure a minimum of 500mm flexible duct is fitted to the plenum to allow removal for maintenance.



Linwood Plenums

Installation Instructions

Return Plenum using metal brackets

Ensure fan coil air filter is fitted to the unit correctly



Hold plenum box onto the air inlet of the fan coil



Mark and fix the top retaining bracket so that it holds the plenum box flange. not too tight but enough to hold a seal against the filter

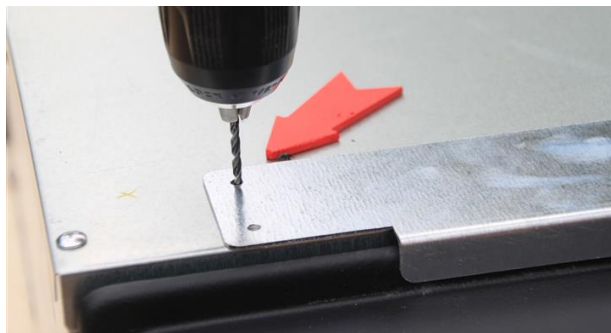

Take the bottom fixing bracket

Align the quick release catches with the rivets located on the plenum flange

Mark, drill and fix bottom the bracket to hold the plenum firmly to the air filter.

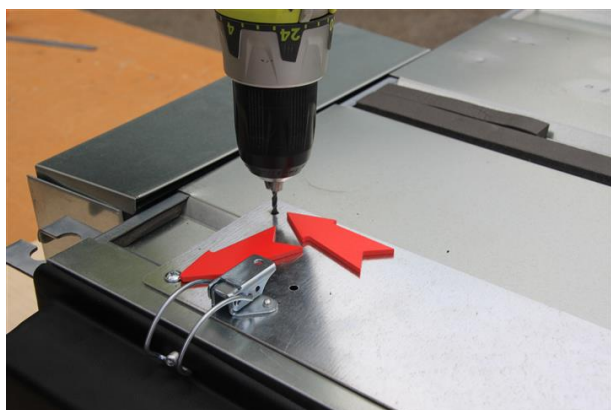

Release all catches

Check that the plenum box can be removed from the fan coil before replacing.

Fit a minimum of 500mm flexible ducting to the air inlet spigots to allow movement when cleaning filters



Linwood Plenums

Installation Instructions

Supply Plenum

Identify dead area inside the air outlet of the fan coil

Fit plenum box over air outlet of fan coil

Ensure dead areas on plenum box and fan coil unit are the same - here shown on the right.

Attach ductwork to the outlet spigots that are open.
DO NOT attach ductwork to spigots that are blank.



Secure plenum box through flange

Use pop rivets or self tapping screws

